

walkbook[®]

walkbook

USER

MANUAL

2008

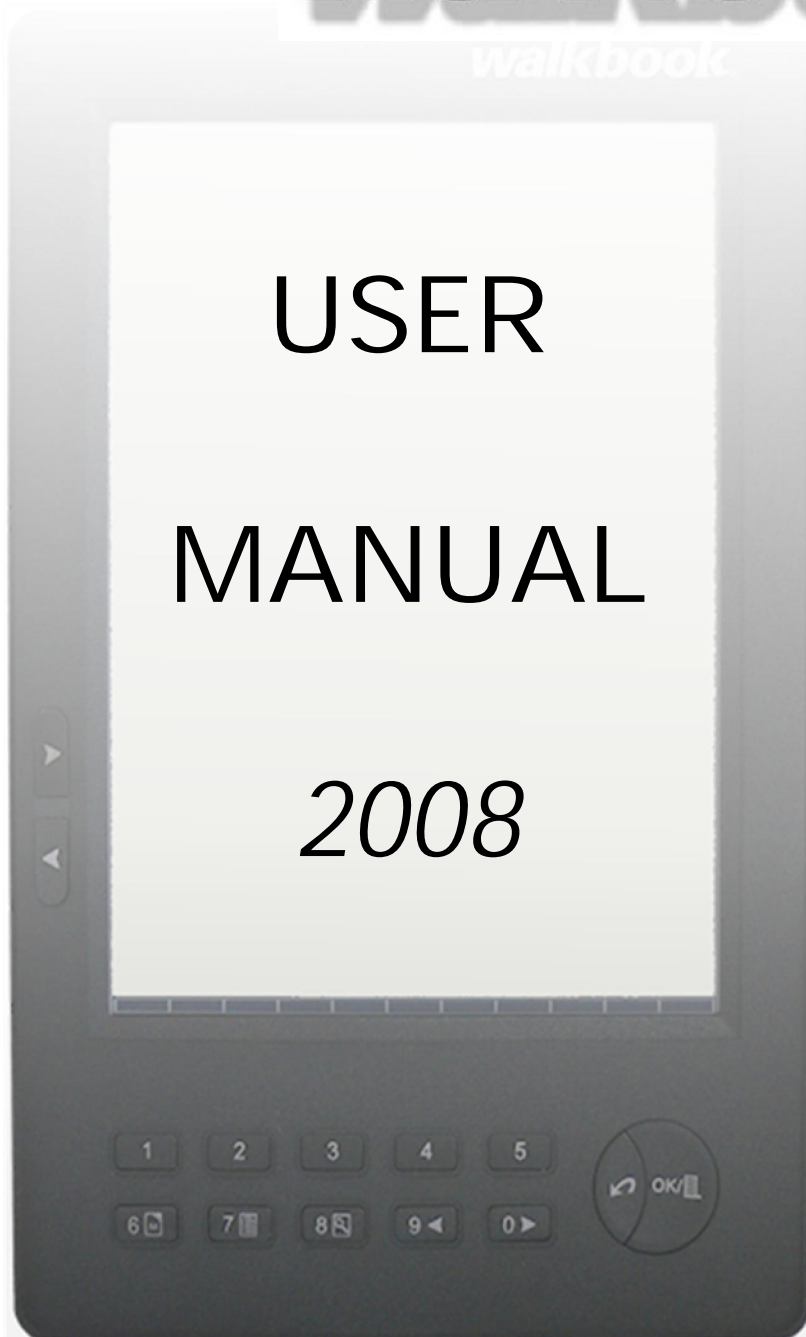

V3

2008.01.09 v1.1

Contents

Safety Notice	1
Structure	2
Operation	3
Installing Battery	3
Charge	3
Installing SD card	4
Switch On/Off.....	5
Keyboard Lock	6
Search.....	6
Searching by turning page.....	6
Search by sorting	7
Search by order.....	7
Recently Read.....	8
Toggle Bookshelves.....	8
Reading eBooks	9
Page Turning.....	9
Page turning by sequence	9
Home/End Page	9
Page Jump	10
Zoom In/Out	11
Bookmark	11
See Index	13
Information of Book	14
MP3	14
System Setting	15
Key Sound.....	15
Language Setting	16
System Update.....	16
System Information	17
USB Connection	18
Specifications.....	19
After-sales Service Guide.....	20

Safety Notice

To safely and efficiently use this product, please strictly abide by the rules, otherwise it may cause problems.

Do not leave the product under direct sunlight, and do not use it in extreme temperature conditions. If you act contrary to these, this may result with the distortion of the product and damage of the electronic components and battery.

Do not leave or use it in a humid environment. Do not let liquid immerge into the product, if affected with water or damp it will cause malfunction of the operation of the internal circuit.

Keep the product on a stable location, avoid severe impact or it will cause the damage to the product and its electronic components.

Do not heavily press the display or place any weight on the display, protect the display from breaking or hurting people.

Do not leave the product in dusty, dirty or corrosive environments.

Do not use chemical solvents to clean the product. Please use the soft cloth to wipe the dust off the surface of the screen or the cover. You can use a small amount of distilled water to clean the dirt on the screen and the cover.

Do not disassemble the product on your own. Only the qualified maintenance personnel or authorized maintenance center can disassemble the product.

Please pay special attention to keep the product and its accessories out of children's reach.

Do not leave the product near magnetic fields; avoid magnetic fields.

Always use authorized accessories, do not use unauthorized components.

Battery:

- ❖ Do not use a rechargeable battery with a damaged surface.
- ❖ If battery leaks please clean the product and use a new battery. In case of a contact with the battery fluid clean the contact point carefully and consult to your doctor.
- ❖ Please properly dispose old and waste batteries.

This product is CE approved.

Structure

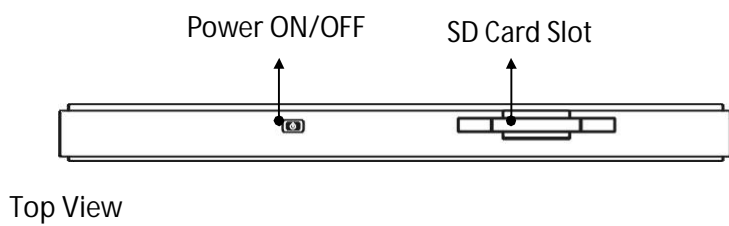
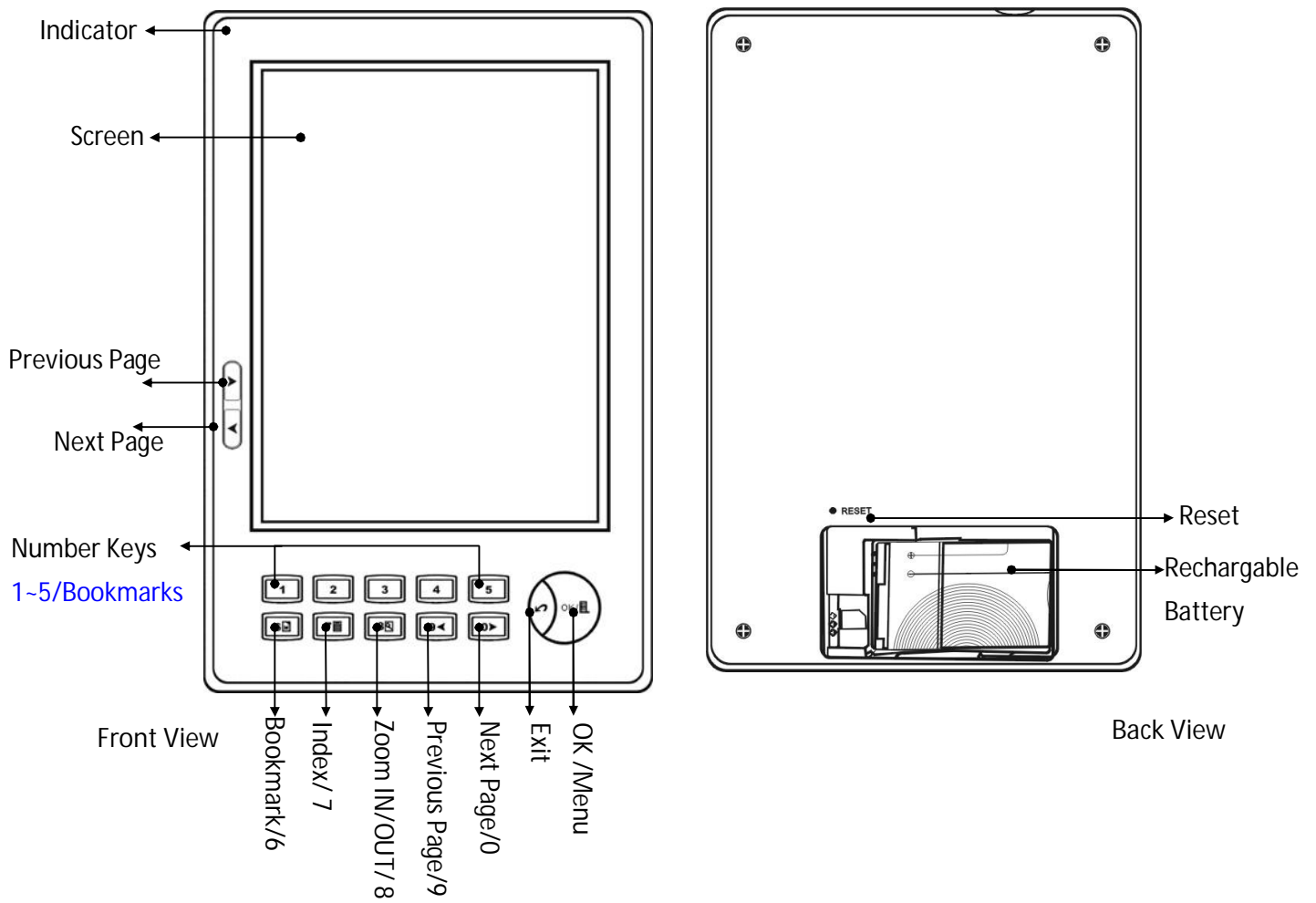

Top View

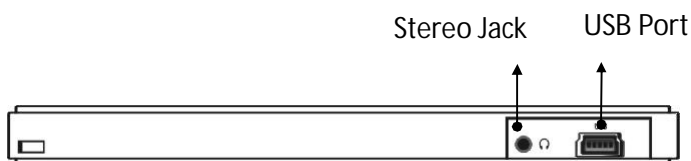

Bottom View

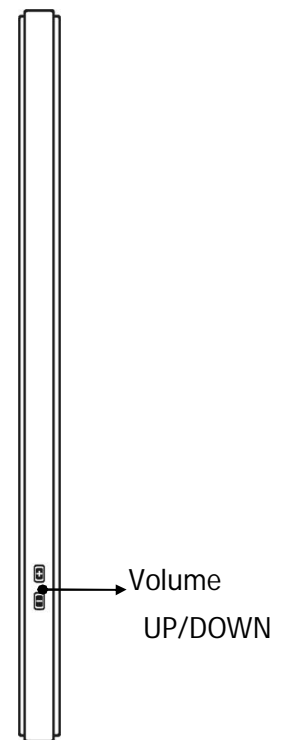

Side View

Operation

Installing Battery

Open the battery cover on the back of the device.

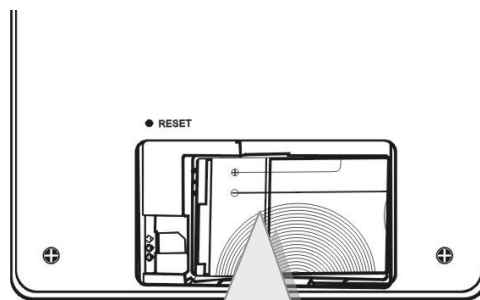

Install the battery according to the instructions on the battery slot.

Charge

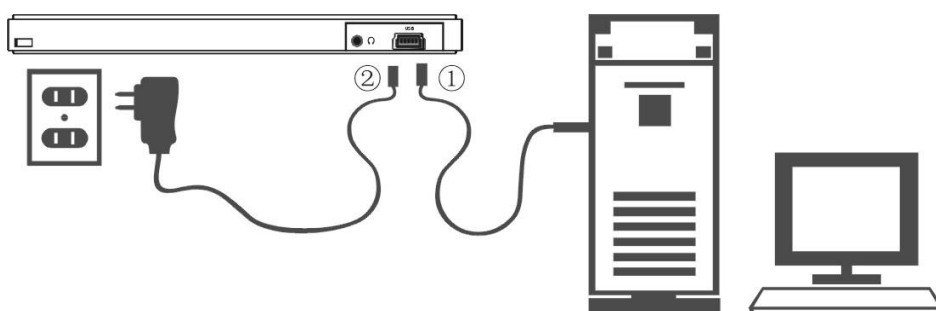

- ❖ This device is powered by a rechargeable battery.
- ❖ Battery should be charged at least twelve hours before first use. Recharging the battery after complete depletion is preferred. Please perform the above-mentioned procedure for the first three uses.

- ❖ Battery can be charged using the USB cable①. Connect one port of the USB cable to the PC and the other port to the device. It takes approximately three hours to charge the battery. The orange light will flash during charging and green light will light steadily when the battery is fully charged.
- ❖ Battery can also be charged by the power adapter.② Connect the device to the power adapter, and plug the power adapter in the socket (please check the voltage scope on the adapter). It takes approximately three hours to charge the battery. The orange light will flash while the battery is charging and green light will light steadily when the battery is fully charged.
- ❖ Do not remove the battery while charging.
- ❖ Battery volume icon is on the bottom left corner of the screen, when the icon shows one grid or system informs low battery, please recharge the battery.



- ❖ The device can be used during charging, but the charging time will increase.
- ❖ One full charge of the battery can support to turn over 10000 pages, and play 9 to 10 hours of Mp3.
- ❖ Do not use unauthorized battery or charger.
- ❖ Do not remove the battery often.

Installing SD card

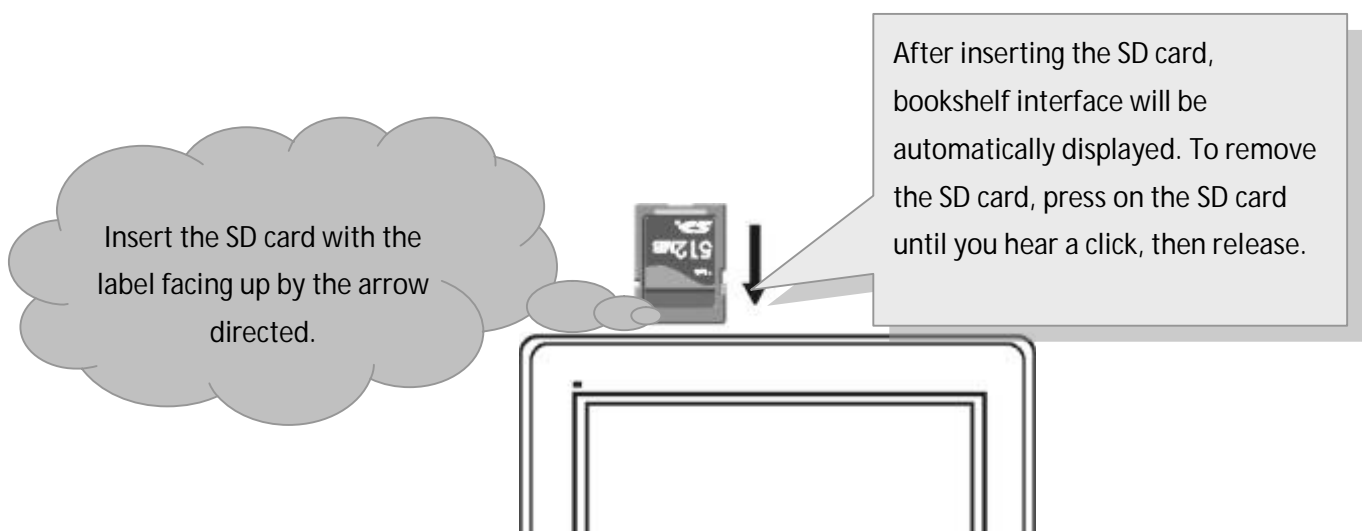

Switch On/Off

Keep pressed on/off button for power on/off.

Switch on :

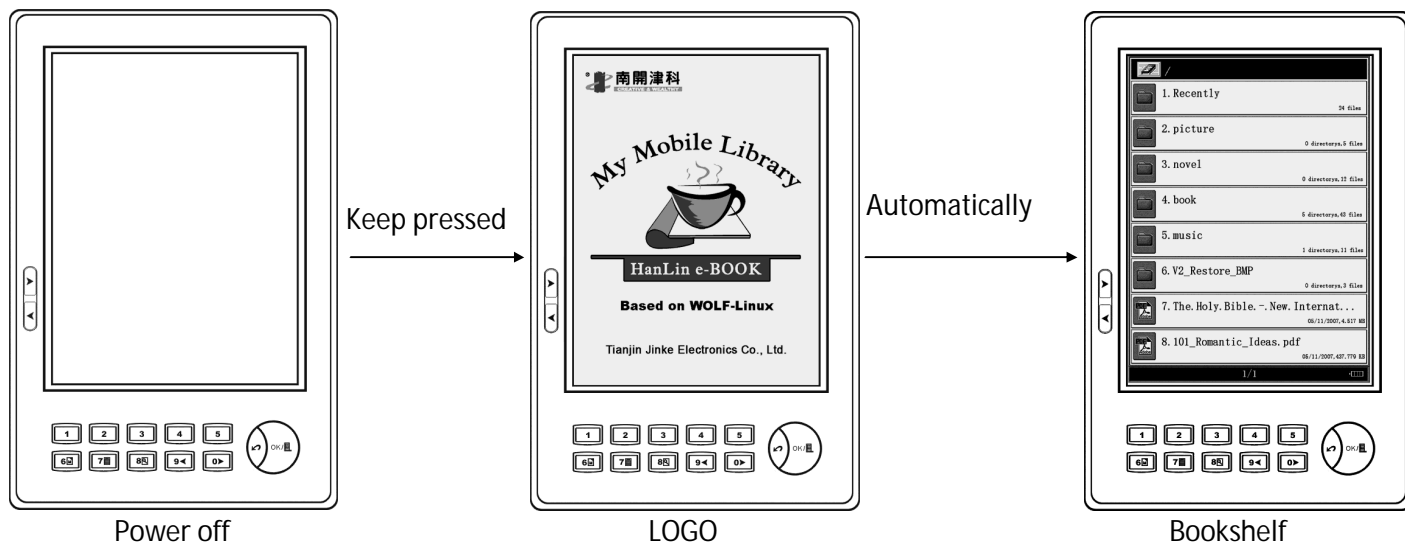

Switch off :

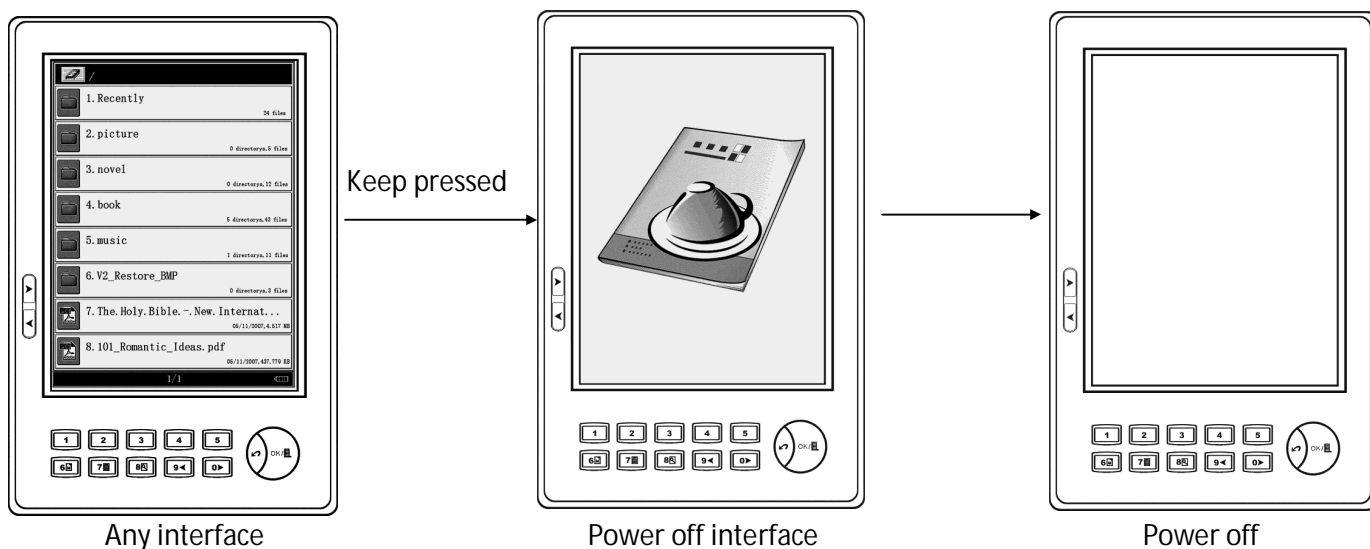

Keyboard Lock

Press once on switch on/off button to lock/unlock keyboard.

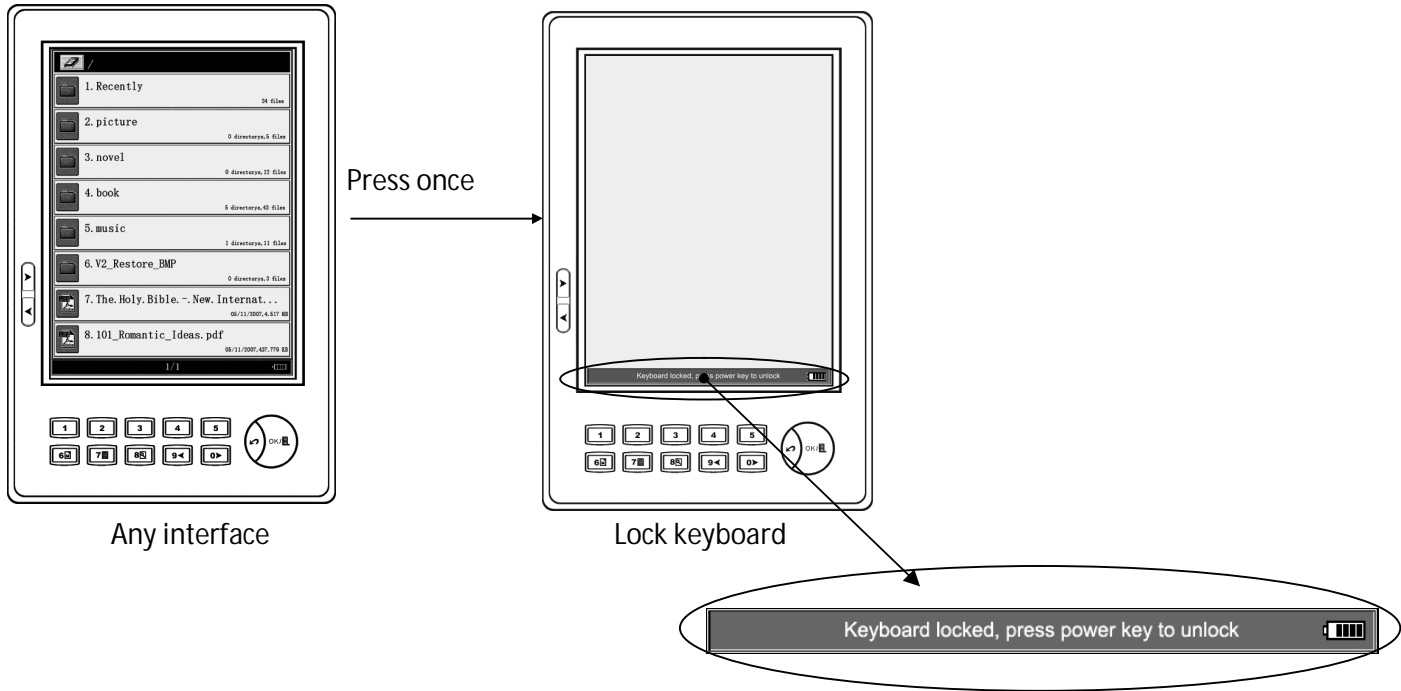

Search

Searching by turning page

Under the bookshelf interface, each page displays eight titles. Press page turning button to previous or next page; Keep page turn button pressed to turn ten pages at a time. User can use number keys (1-8) to select the title for reading.

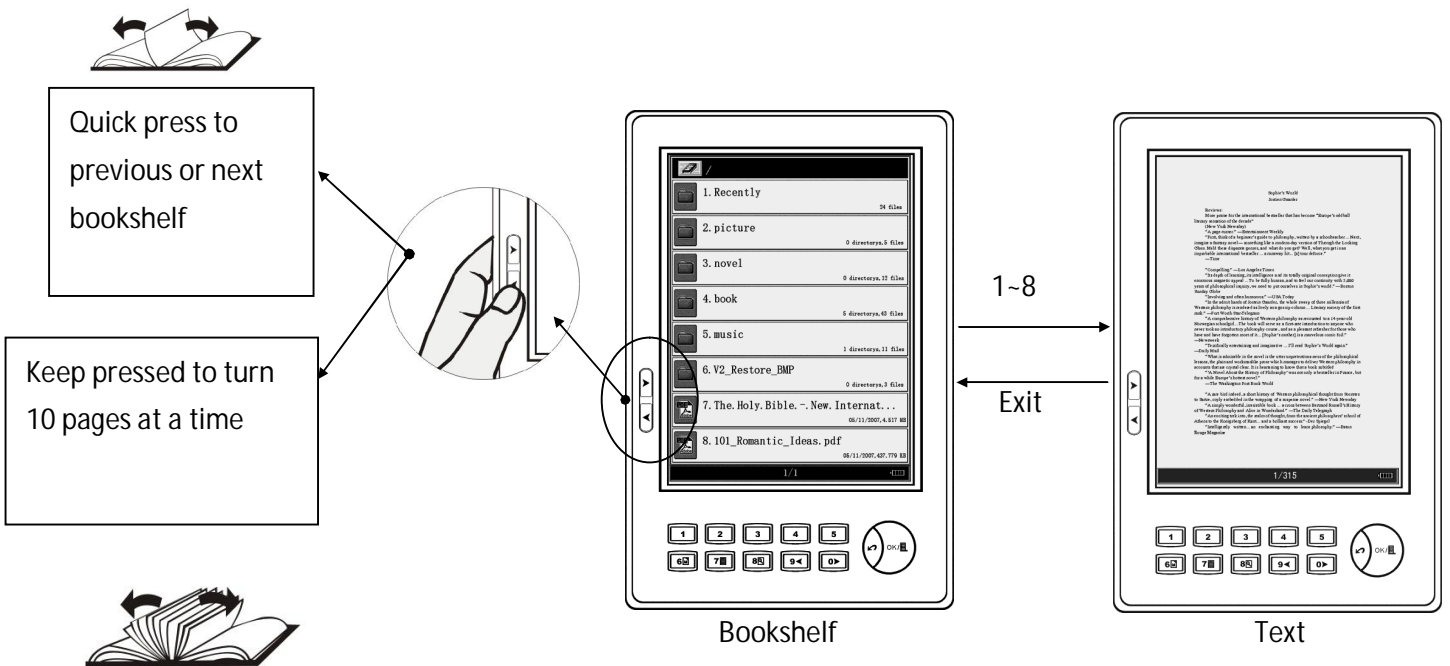

Search by sorting

User can save the books of a sort in the same folder. The device can support multi-level folder. Press the number keys (1~8) to enter into the sub-folder.

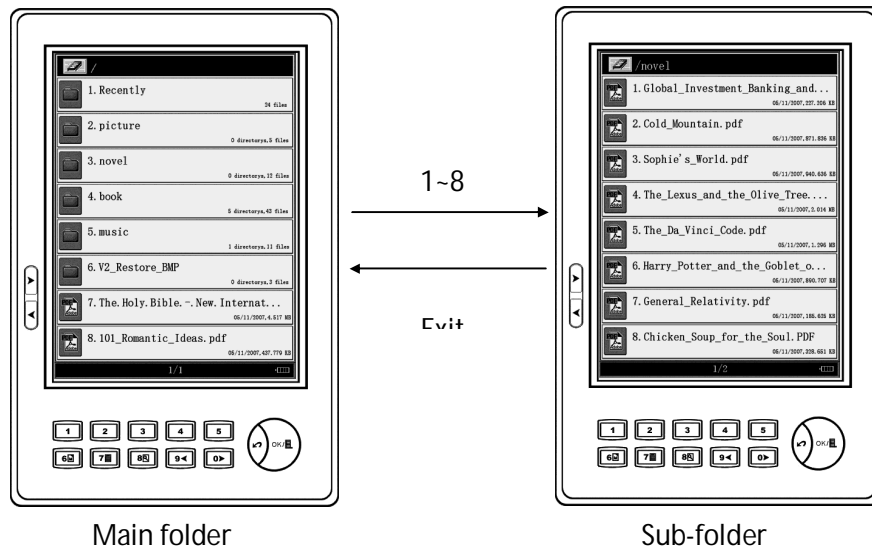

Search by order

Under bookshelf interface, press OK to display the menu, press number keys 2~4 to choose the order methods.

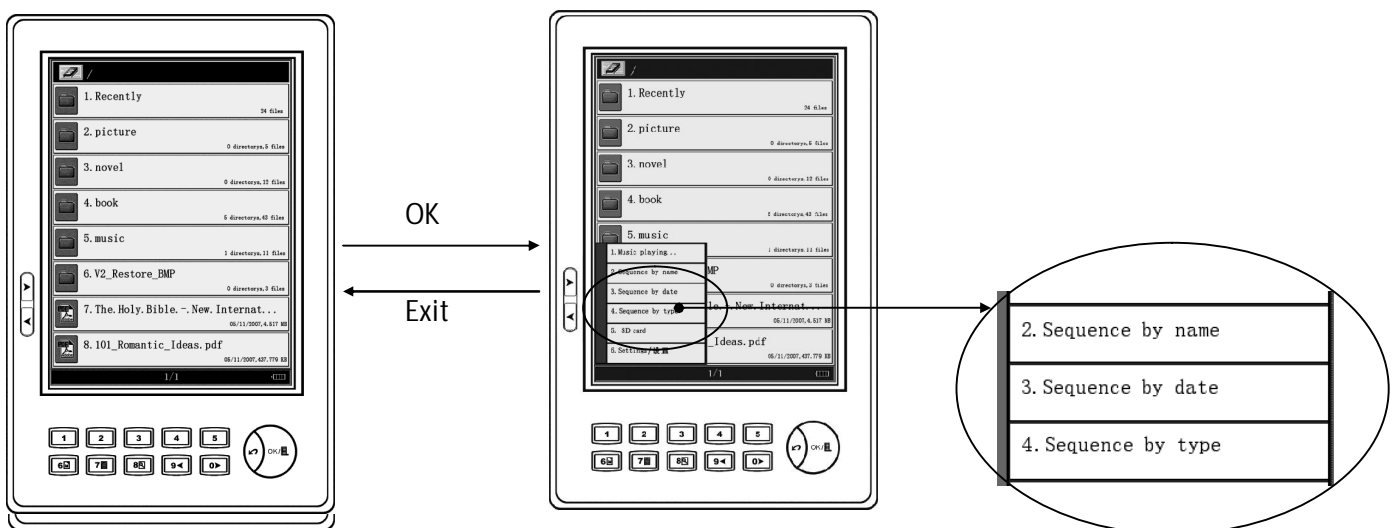

Recently Read

Recently Read: The books which recently read can be saved in the "Recently" folder.

In the home page of the main bookshelf, press number key 1 to enter into "Recently" folder.

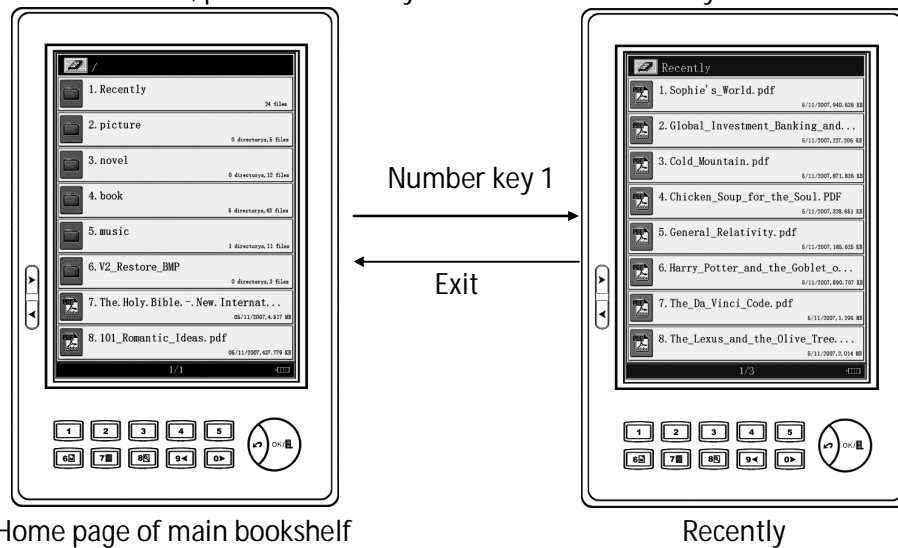

Toggle Bookshelves

Under bookshelf interface, press OK to show menu; pressing number key 5 can toggle between the bookshelves of SD card and internal bookshelves.

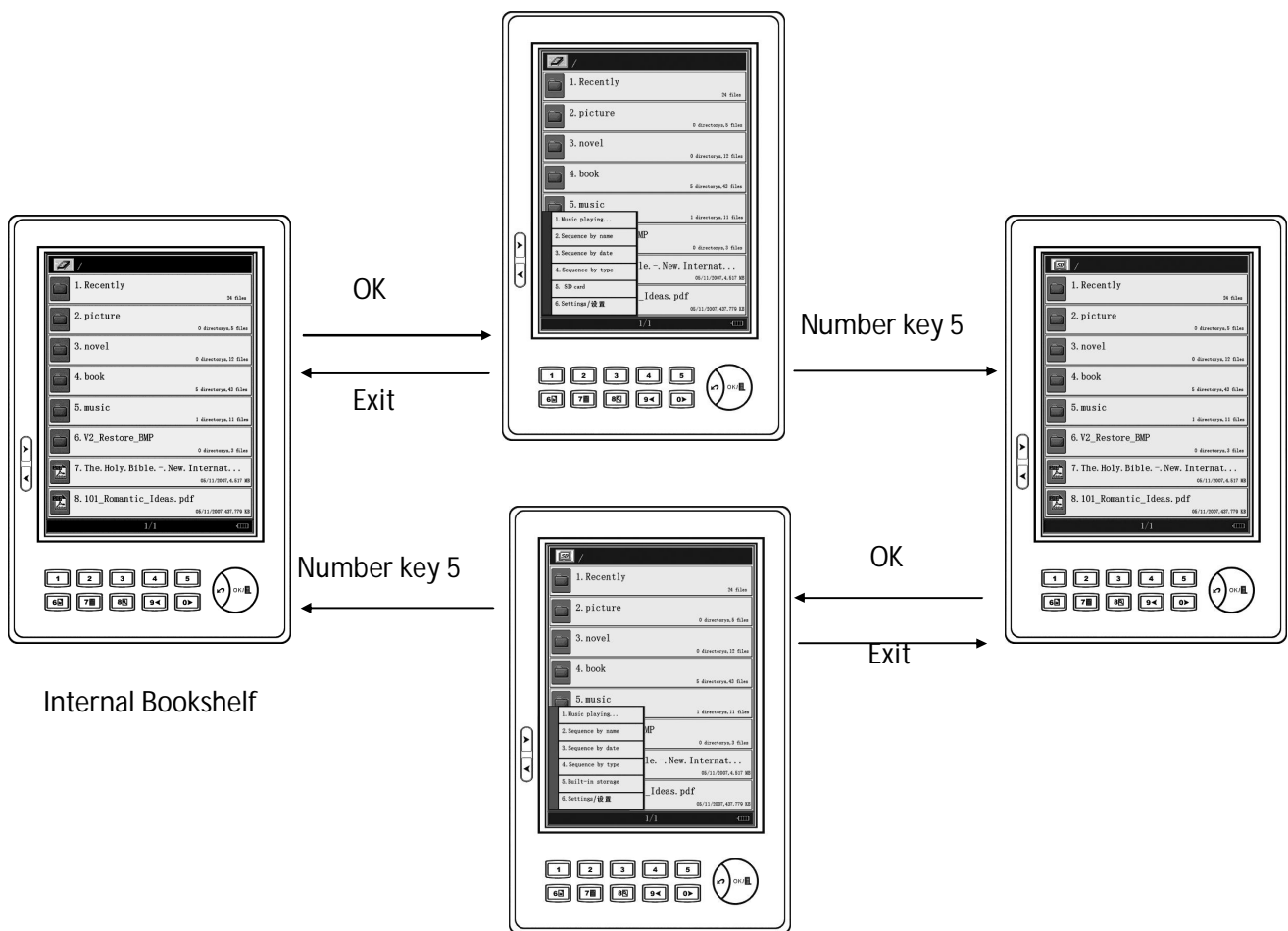

Reading eBooks

Page Turning

Page turning by sequence

Under text interface, press page turning button or number key 9 and 0 to turn pages by sequence.

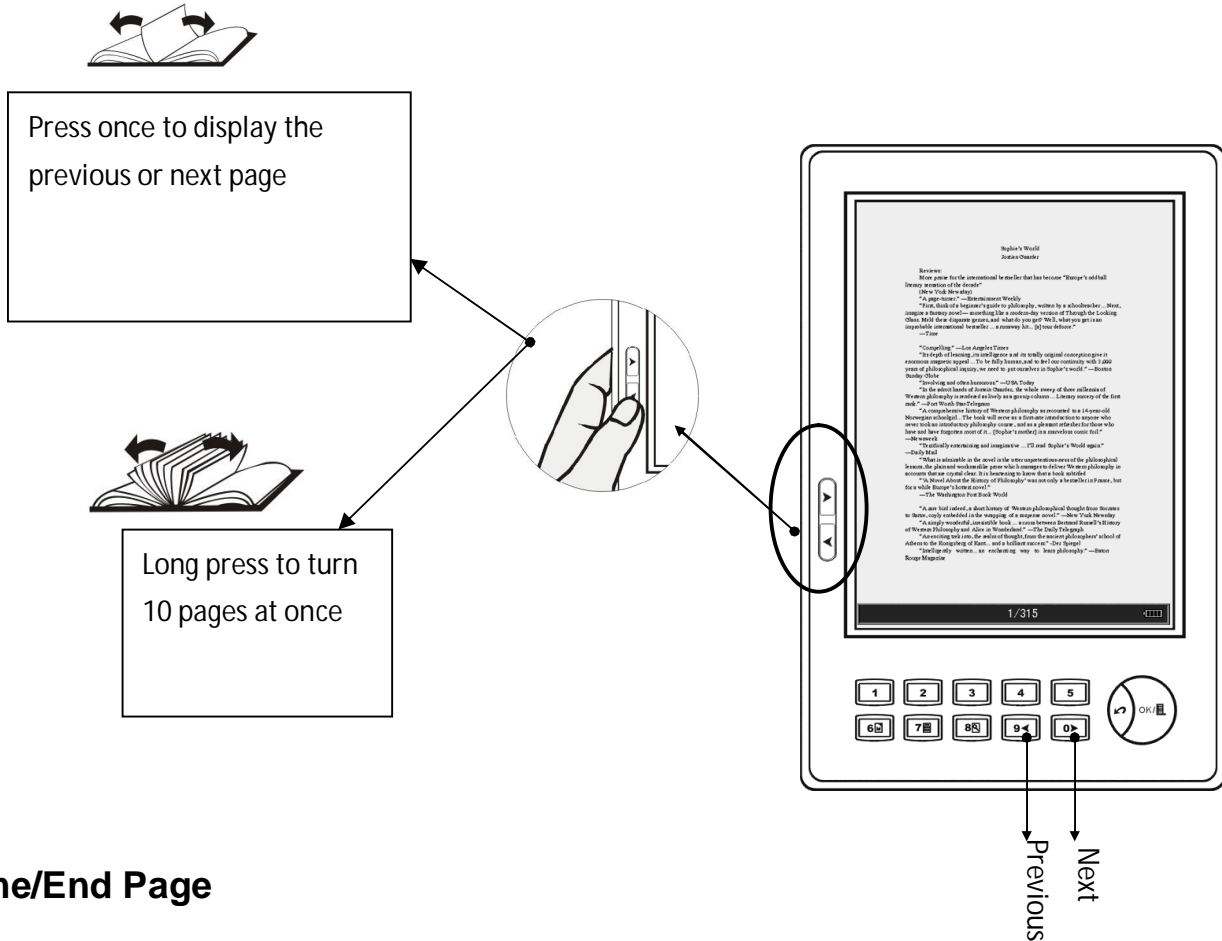

Home/End Page

Under text interface, press OK to display the menu, then press 1 to display the home page; press 2 to display the end page. (Images file don't support this function.)

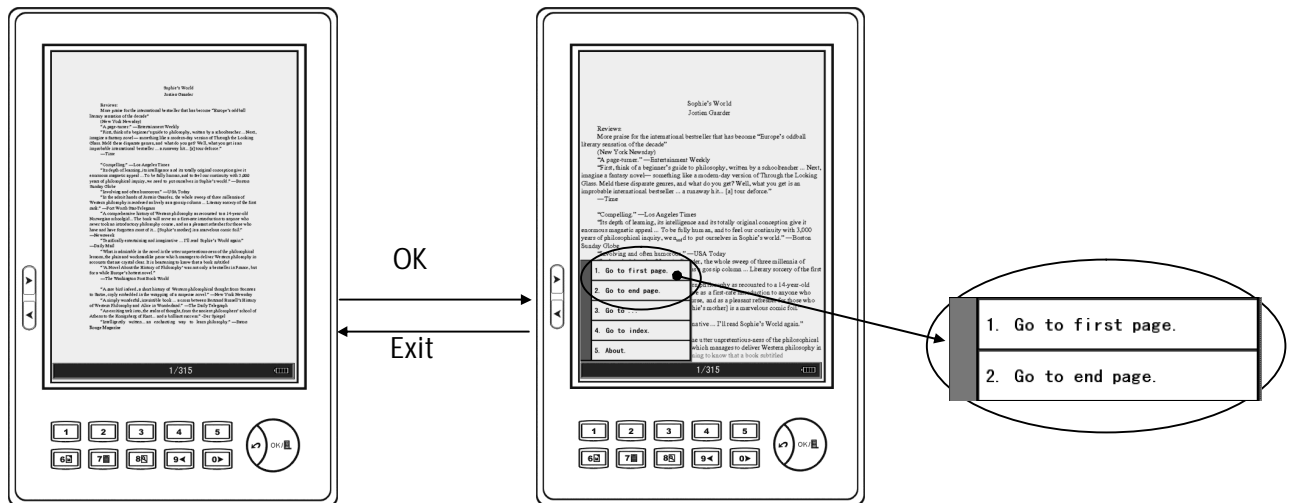

Page Jump

Under text interface, press OK to display the menu, and then press 3 to enter into the jump page function. (Images file don't support this function.)

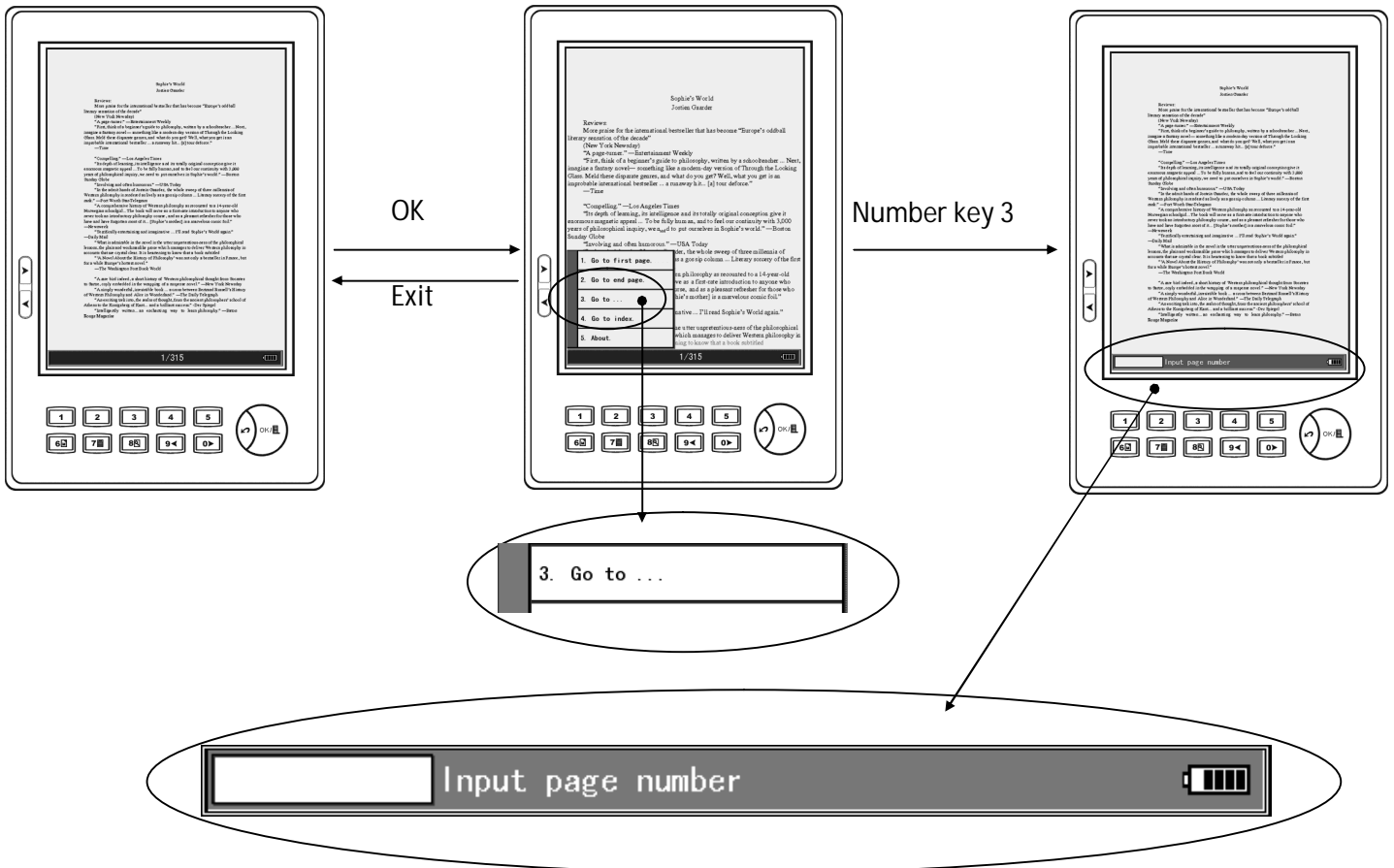

Press 0~9 to enter the page number and press OK to jump to that page.

During process of entering the page number, press Exit to delete the entered number. If no page number entered, press Exit to quit this function.

Zoom In/Out

Three levels zoom in/out: Normal, Full screen, Double.

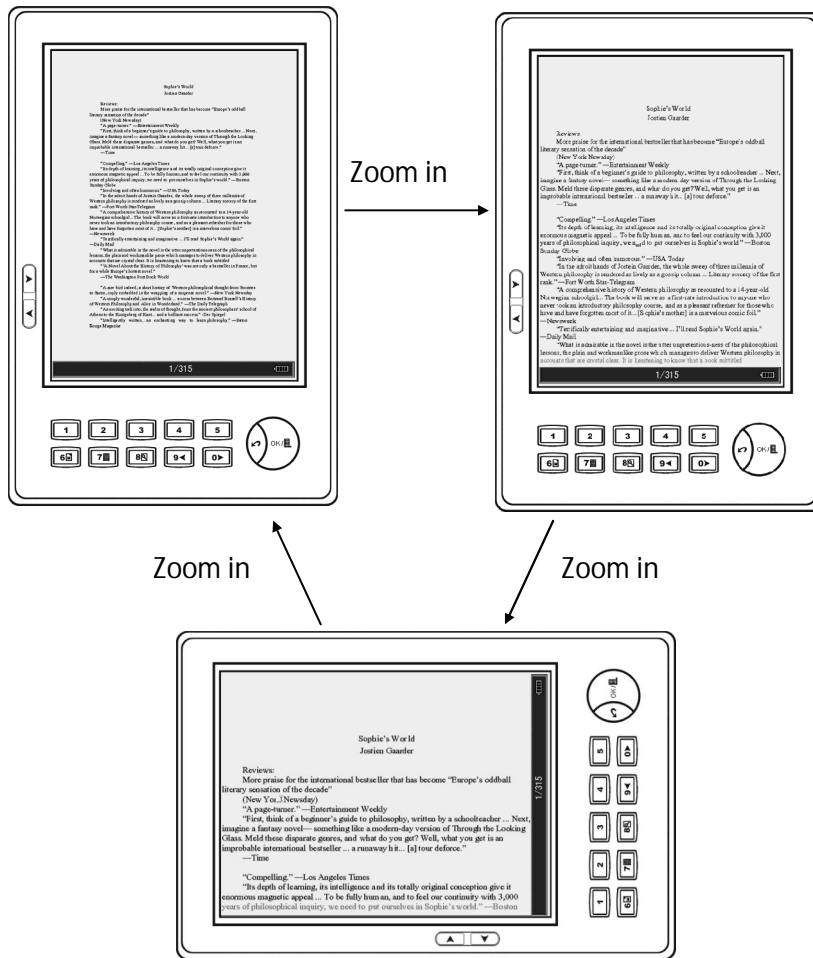

When it is in Double mode, the text will be displayed horizontally.



Bookmark

Number keys 1~5 : Bookmark

Bookmark operation :

-  The current page without bookmark
-  The current page with bookmark

If the number keys aren't used as bookmark, the icon of the number key won't show in the status bar.

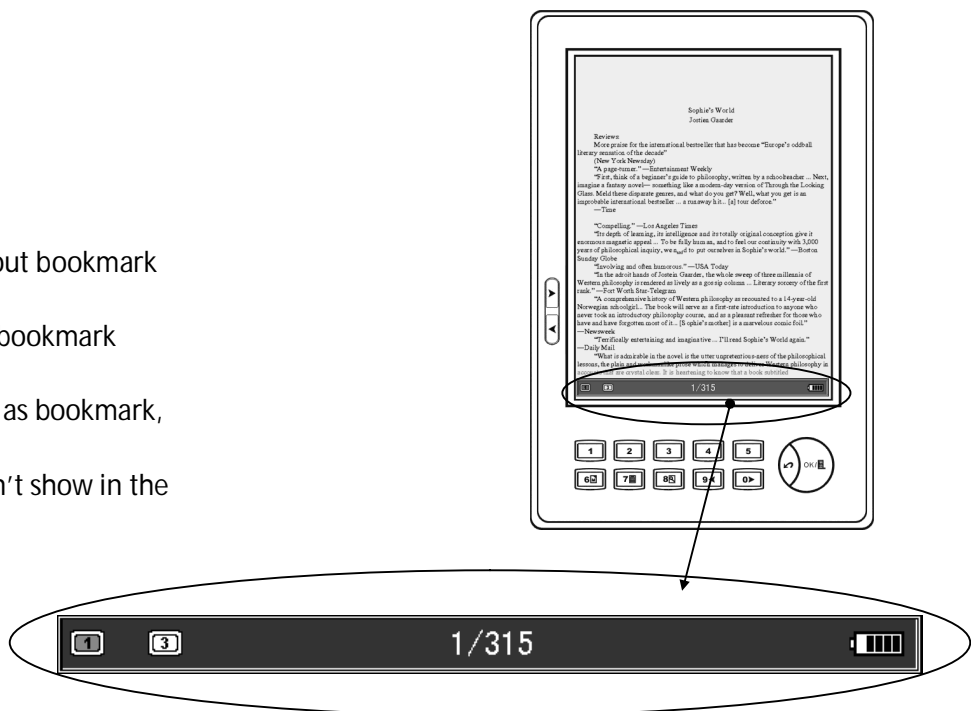

Add Bookmark:

Press number keys 1~5 to directly add bookmarks.

Replace Bookmark:

If the current number key you want to use as the bookmark is already used, you may keep the current number key pressed for 2 seconds, and then the previous page bookmark will be replaced with the current page.

Clear Bookmark:

Go back to the page with bookmark; press the number key to clear the bookmark.

Check Bookmark:

Keep pressed number key 6 for 2 seconds to enter into bookmark status checking, then all the details of the bookmark will be listed. Select the bookmark to go to the page with bookmark. Press number key 1~5 to jump to the page with bookmark.

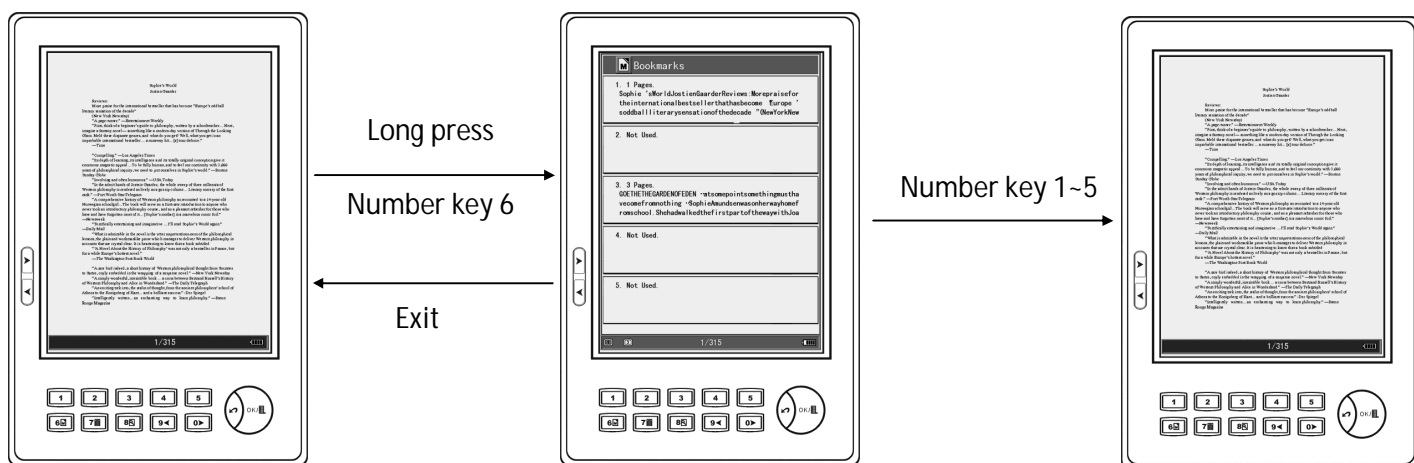

See Index

Under the text interface, press "Go to index" button to enter into the catalog interface, the system can support multi-level index. Press number keys 1~8 to enter into the index of next level, if the current index is the last level index, press the number key go to the chapter of the book or press Exit to return to previous level index. (TXT, HTML, Images file don't support this function.)

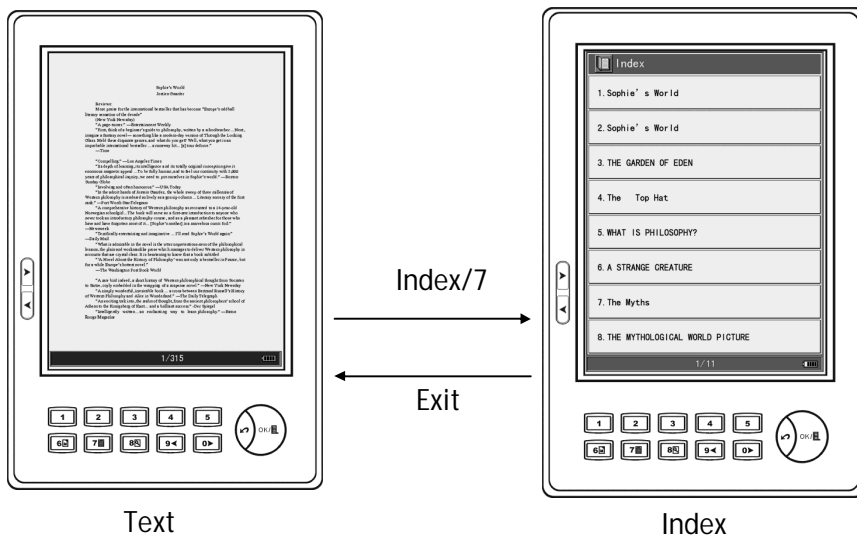

Under the text interface, press OK to display the menu and select "Go to index" by pressing the number key.

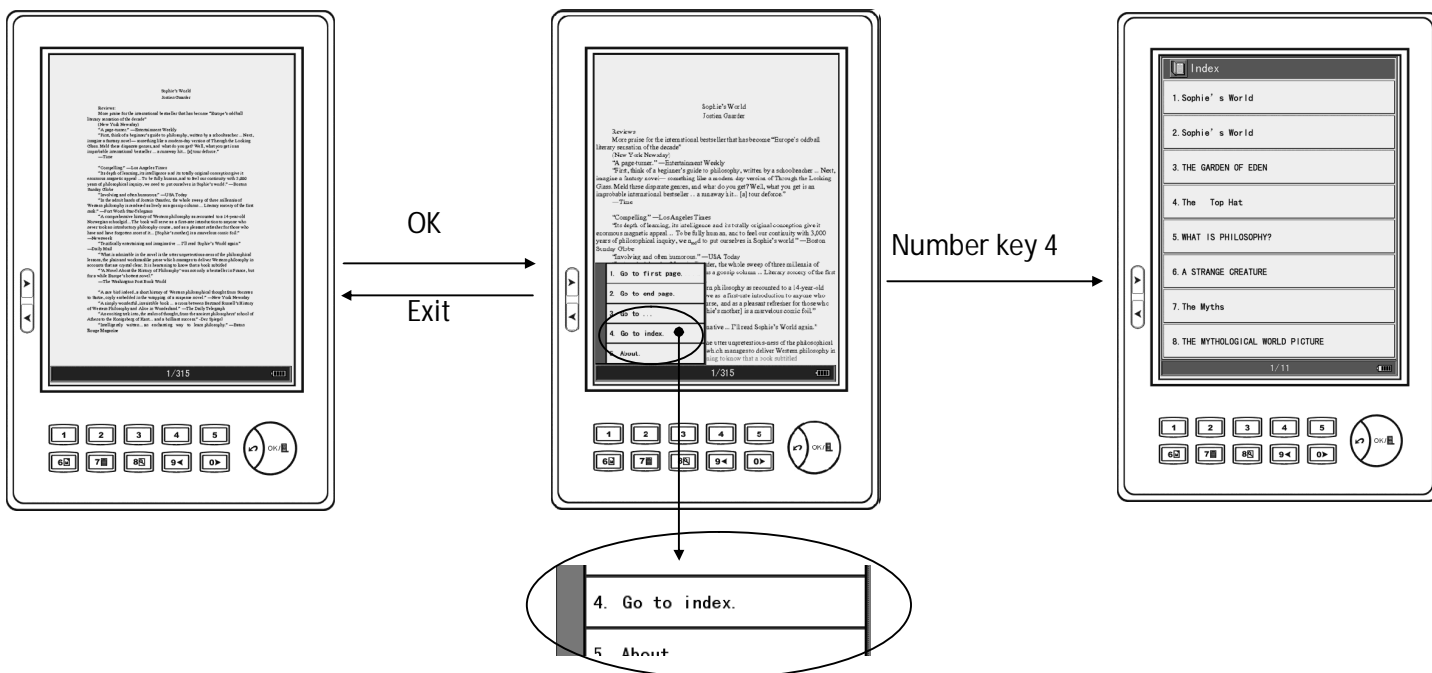

Information of Book

Under the text interface, press OK to display the menu, and select the "About" by pressing the number key, then all the information of the book will be displayed, which include ISBN, author, file name publisher, publishing date, copyright, price etc. (Different book may have different items.)

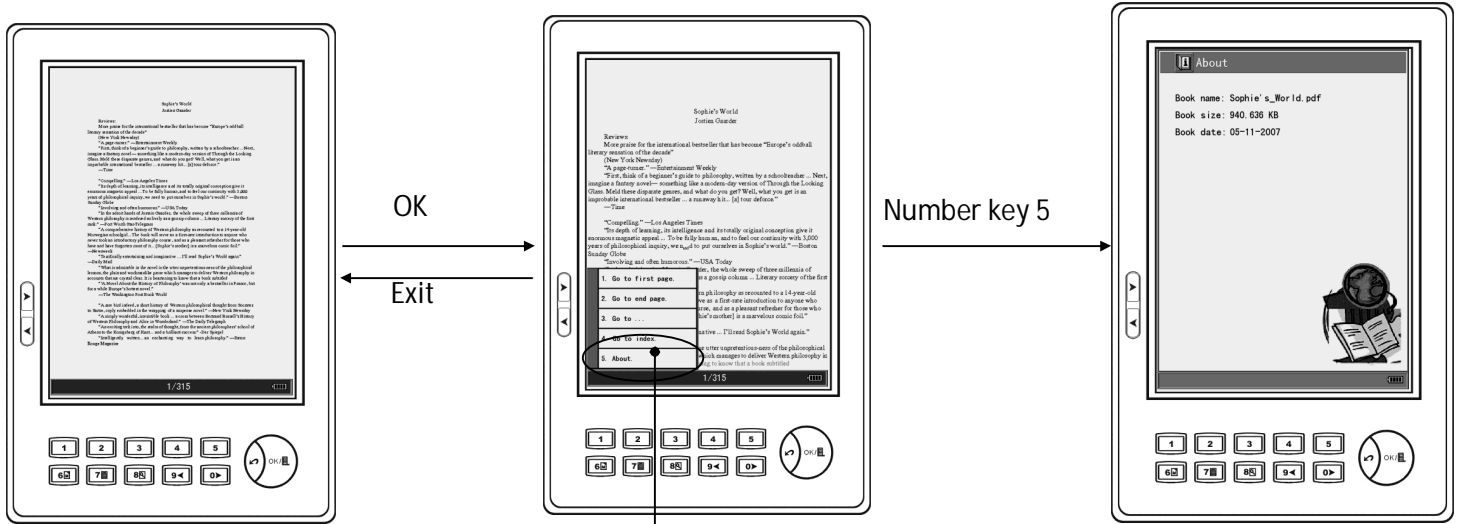

MP3

Under the bookshelf interface, press the number key to play the MP3 file. During the playing process, press OK to display the menu, and then press number key 1 to enter into Music Play function.

The Music Play function will display the all information of the current MP3, including song's name, baud rate, playing time etc.

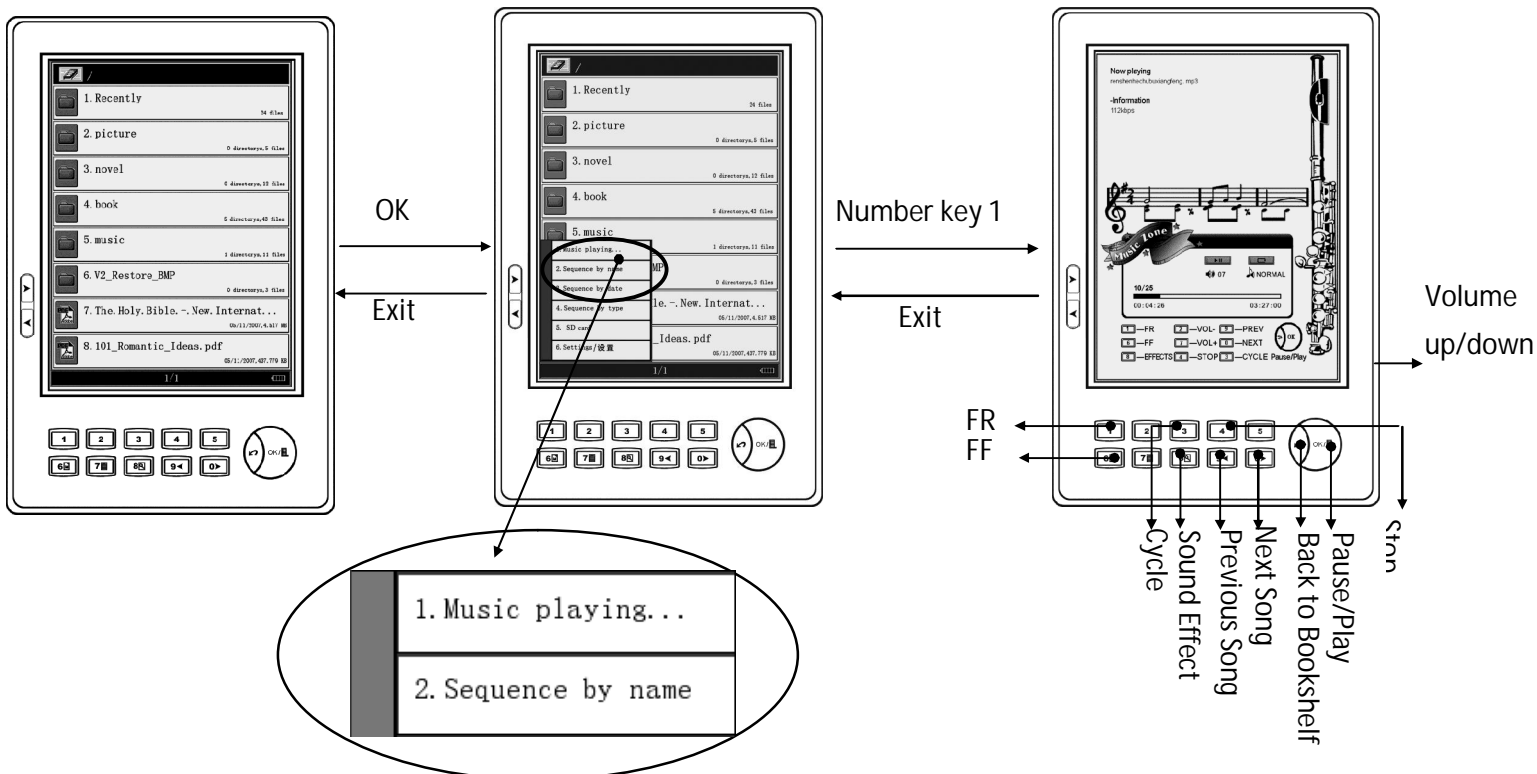

System Setting

Under the bookshelf interface, press OK to display menu, press number key 6 to enter into the system setting function, which includes sound key setting, language setting, system update and product information.

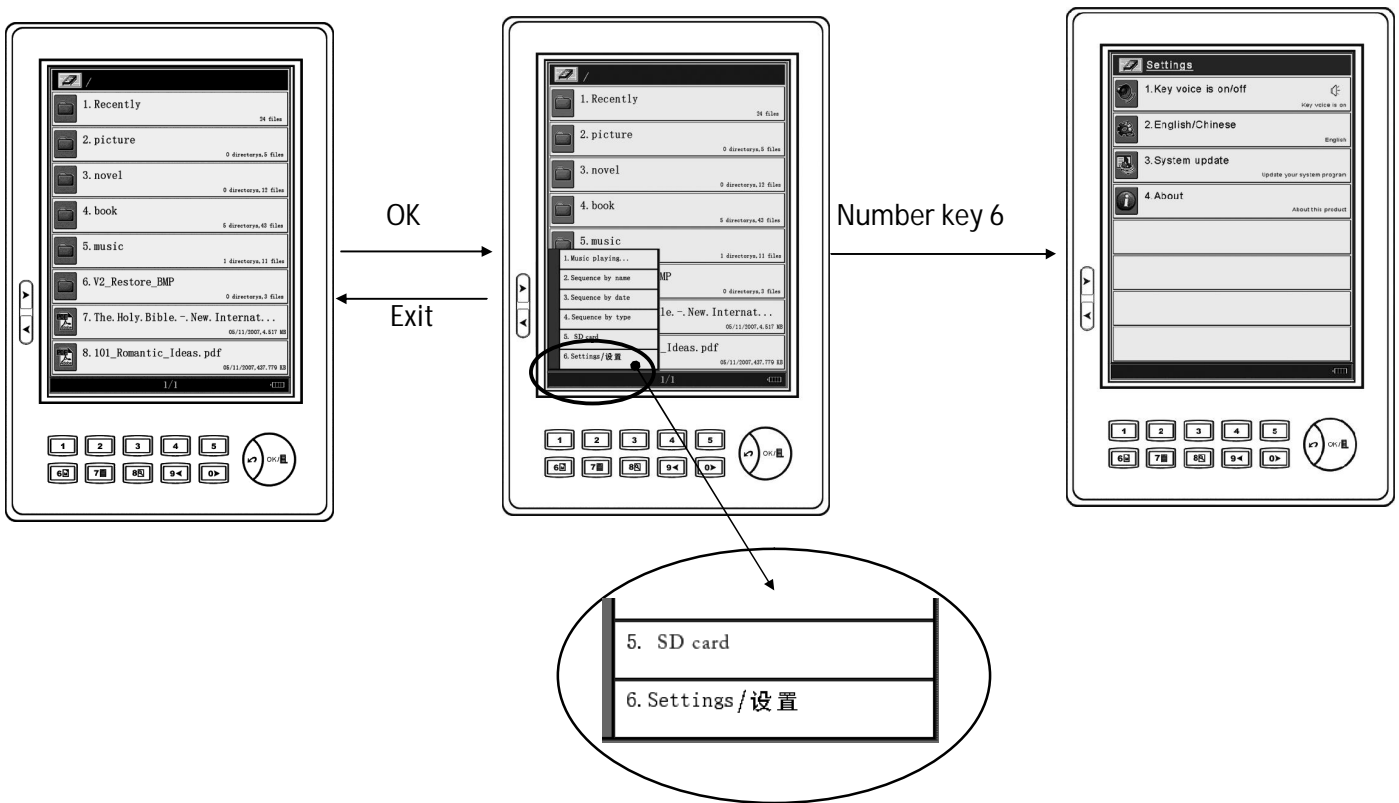

Key Sound

Under the system setting interface, press number key 1 to open/close the sound of the key.

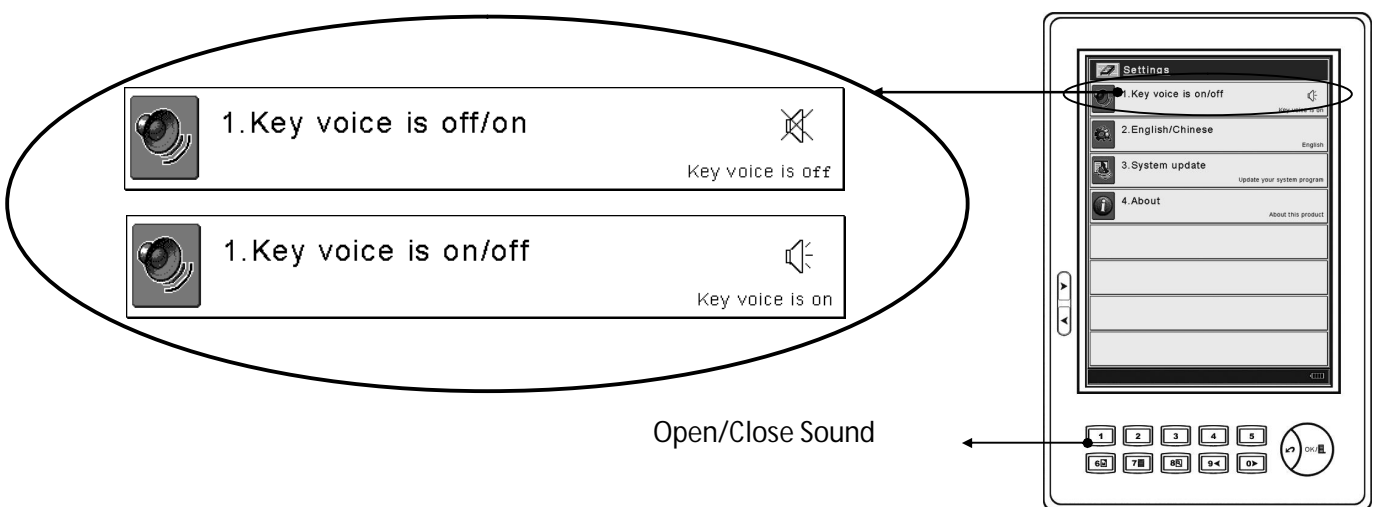

Language Setting

Under the system setting interface, press number key 2 to enter into language selection interface, select language by pressing the opposite number key.

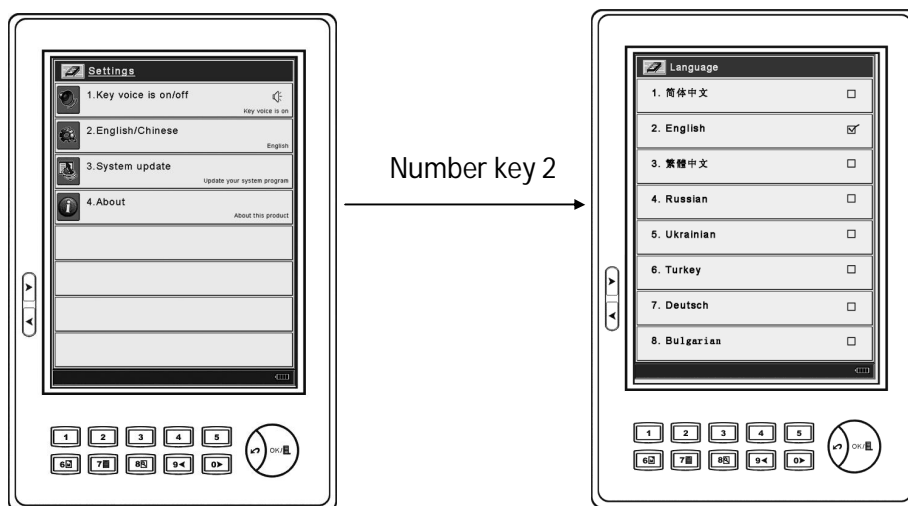

System Update

First place the update file in the root directory of the SD card, then under the system setting interface press number key 3 to begin the update. After update, the system will automatically reset.

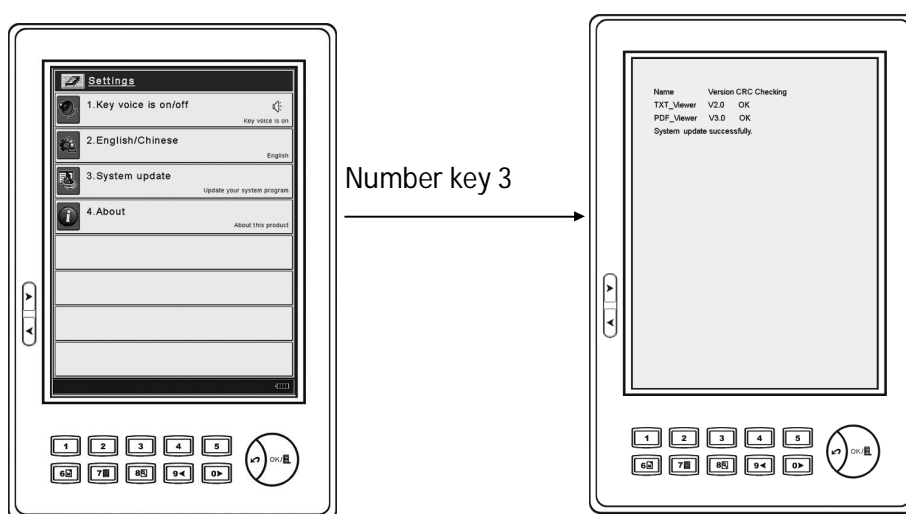

System Information

Under the system setting interface, press number key 4 to check the information of system version.

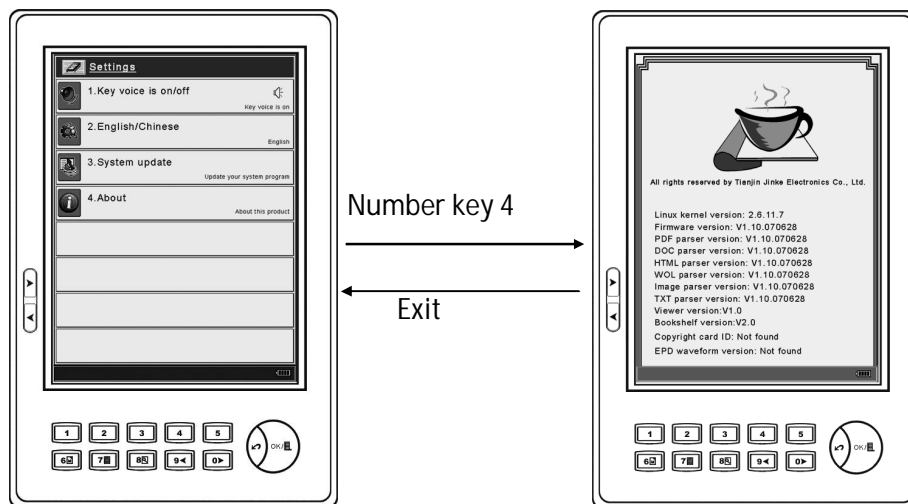

USB Connection

The device can directly connect to a computer which support plug and play through the USB cable. After connecting the device, a "Removable disk" item will automatically be displayed in "My Computer". (Note: Until the device is disconnected, reader features will not work.) See the following picture:

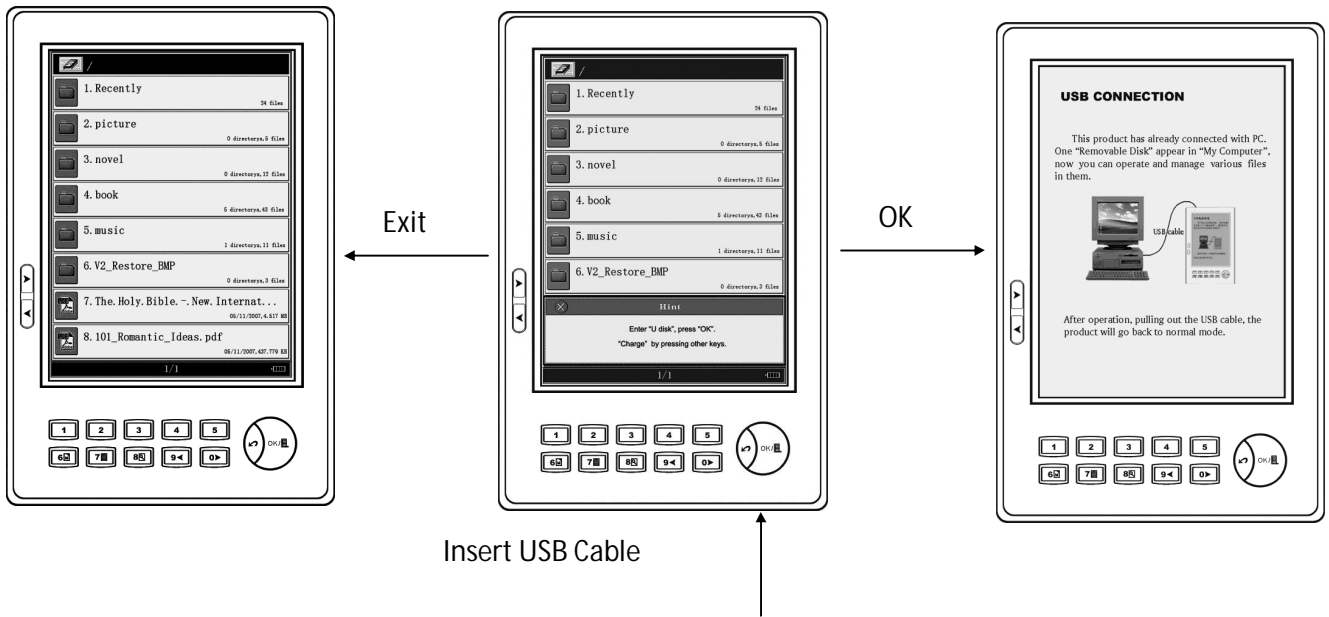

How to confirm to copy the data to the SD card

In Windows systems, data won't be copied to the SD card immediately, instead the data will first be copied to the cache, therefore it needs to confirm.

Confirmation Method: When the indicator don't flicker, click the "Removable disk" with the right button of the mouse, select "Eject" from the menu (In Windows 2000 or Windows XP, need to select "pull out or eject hardware"), then pull out the USB cable.

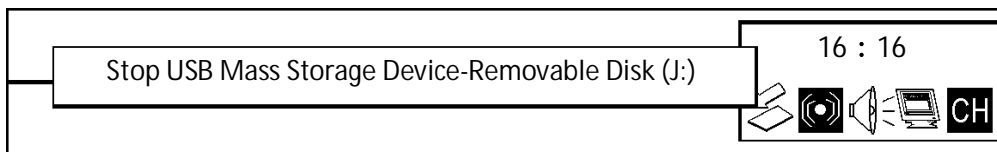

After pull out the USB cable, it will go back to the bookshelf interface, and then you may read the books with the SD card.

Specifications

Hardware	CPU: Samsung Arm9 200MHz
Screen	ePaper (E-Ink technology) 6 Inches 600*800 pixel 4 grayscale
Dimensions	184mm(L)x120.5mm(W)x9.9mm(H)
Operating System	Linux OS
Format Natively Support	PDF, TXT, DOC, HTML, MP3, WOL, IMAGES
Memory	SDRAM:32MB, Internal 2MB NOR FLASH
I/O	3.5mm stereo audio jack for earphone USB 1.1 Port SD slot (up to 4GB)
Weight	220g (include battery)
Battery	Li-ION 950mAh
Working Temperature	0°C to 40°C
Keeping Temperature	-20°C to 55°C

After-sales Service Guide

Terms of Limited Warranty Service

Under the terms of Limited Warranty Service, UBiT will provide free repair for any problems of quality.

The Warranty period of 12 months on the product (without present) starting on the original date of purchasing and 3 months on accessories that means UBiT provides warranty service without charge for: limited repair and free maintenance (not including the fault and damage caused by wear material, artificial factors by customer and non-quality problem etc.)

The appearance of product in the warranty period without nick and artificial damage, with invoice (valid receipt), warranty service card (kept by customer), these will be the proof for after-sales service. UBiT can check the warranty service card of customer. (This filled in by customer, and sends it to UBiT) If after repair, the products still appear the same fault, which can be exchanged (not including accessories and present). If you have any questions, please contact service department of UBiT.

The warranty period for the repaired product is the rest time of warranty period, or 90 days starting from the repairing date. The longer time is counted as the warranty period.

Under the requirement of UBiT or its licensing service center, customer should provide invoice (valid receipt) and warranty service card, or other information which can prove the date and place of purchasing the product.

Costs involving product shipment UBiT or its licensing service center should be covered by customer.

What this Warranty Does Not Cover:

- ❖ Damage resulting from user related impacts, collision, shedding and misuse;
- ❖ Damages resulting from storing under improper conditions; exposing to unsuitable environments such as humidity, extremely high or low temperatures, exposing to food, smear or liquids.
- ❖ Failure resulting from change, connection, repair (using spare components other than that are authorized by UBiT), misuse, careless usage, abuse, accident, modification and incorrect installment, faulty operation by customer, or other factors surpass the reasonable usage and control of UBiT, including using without cover.

-
- ❖ If UBiT never receives notice of failure or performance problems about the product from customer within the warranty period.
 - ❖ Deleted, damaged, altered or forged series number of the product.
 - ❖ Any non-UBiT products, including those that UBiT may not procure and provide with or integrate into UBiT product.

Within the warranty period, customer should act as:

- ❖ Product or accessories should be sent to the local seller for repair or exchange.
- ❖ Product or accessories should be sent to licensing service center.
- ❖ Customer will receive the bill of the repair which without the limited warranty.
- ❖ Customer will pay expenses of re-installment of the product.
- ❖ If the warranty period expires, the expenses of maintenance and service will be charged according to the general service policy of UBiT, and provide a 90 days warranty period after the paid repair. And the product will enjoy the policy of after-sales-service for life.

Benefits provided by this warranty append on the all rights and compensation of the compulsory laws in any country (or regions).

UBiT is not responsible for the responsibilities and obligations that surpass those that are announced in this warranty, and do not authorize its licensing service center or entity to bear.

No advanced notice is compulsory for any change of all terms of warranty, product functions and specifications.